

# TFIX-8ST-TOOL SETTING TOOL

Accessory for installation of screw fixing TFIX-8ST with T40 bit



## Product information

### Features and benefits

- Integrated disc facilitates optimum TFIX-8S installation, setting the flange flush with the surface of the insulation
- User-friendly - enables fast and easy installation
- Torx-40 bit type

### Applications

- Façade construction (ETICS)
- Polystyrene boards
- Polyurethane boards
- Mineral wool

## Installation guide

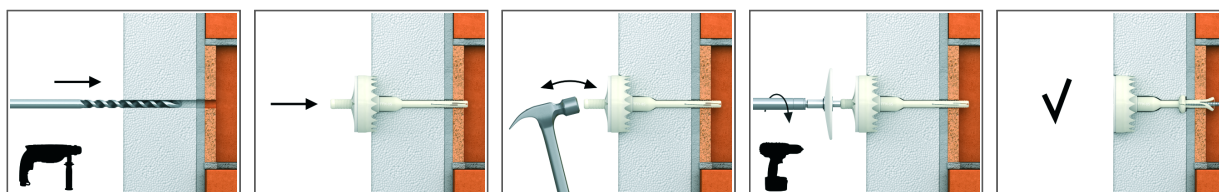

1. Drill a hole of required diameter and depth
2. Lightly tap the plastic sleeve through the insulation material into hole with a hammer, until fixing depth is reached
3. When using the TFIX-DEVICE the teeth should be embedded in the insulation material after hammering.
4. Embedment depth of min 25mm in A,B,C,D materials and 65mm in Aerated Concrete Block
5. Drilling depth of min 40mm in A,B,C,D materials and 80mm in Aerated Concrete Block
6. Apply steady axial pressure, ensuring the disc of the setting tool is kept perpendicular to the fixing axis.

### Product information

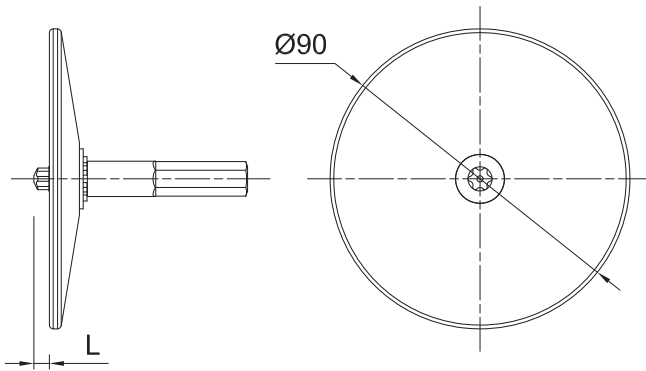

Product Code	Bite type	Diameter	Length
		d	L
		[mm]	
TFIX-8ST-TOOL	torx-40	90	15

### Product commercial data

Product Code	Diameter [mm]	Length [m]	Quantity [pcs]			Weight [kg]			Bar Codes
			Box	Outer	Pallet	Box	Outer	Pallet	
TFIX-8ST-TOOL	90	15	1	16	384	0.30	4.8	145.2	5906675056654